

MANHOLE BOX-OUT

DIMENSIONS OF BOX OUT SHALL BE AS APPROVED BY THE CITY ENGINEER

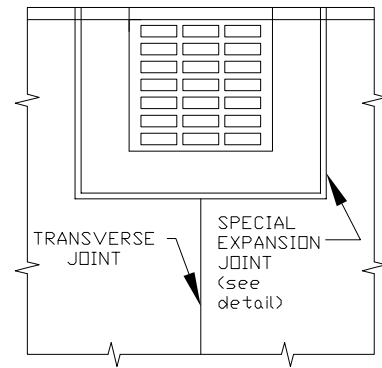

INLET BASIN BOX-OUT

All inlet basins may be separated from the pavement and curb by boxing out around basin as shown above. Expansion material shall extend completely through curb and slab. Manhole castings within the pavement limits may be boxed in like manner except when adjusting rings are used.

When a joint falls within 5 feet of, or contacts basins, manholes or other structures, shorten one or more panels either side of opening to permit joint to fall on round structures and at or between corners of rectangular structures.

TIED CONCRETE PAVEMENT ALTERNATE DETAILS AT STRUCTURES

FRANKLIN
ENGINEERING DEPT

FIGURE 6